

NYLATRON® SHEAVE (Casting Sheave)

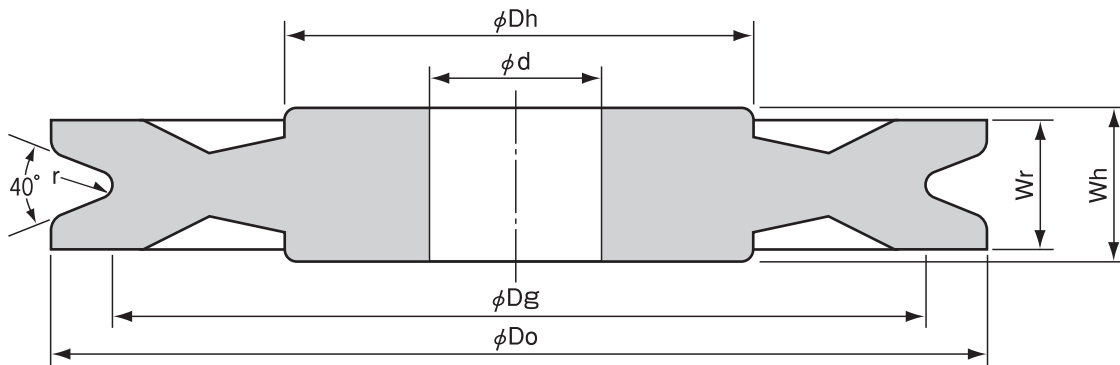

● Blank material with ditch (Sheave Ratio 20)

No.	Applied rope diameters mm	Do mm	Dg mm	Dh mm	d mm	Wh mm	Wr mm	r mm	Possible pressurized insertion bearing outer diameter mm	Maximum allowable weight N	Weights g/pc
2013	12.5	281	244	138	50	45	35	6.5	55~100	68,647	2.1
2014	14	315	272	150	60	50	40	7.5	65~110	88,260	2.9
2016	16	360	310	174	80	55	45	8.5	85~130	117,680	4.2
2018	18	405	348	198	90	60	50	9.5	95~150	147,100	5.8
2020	20	450	386	210	110	65	55	10.5	115~160	156,906	7.5
2023	22.4	504	432	235	120	70	60	12	125~180	176,520	10.3

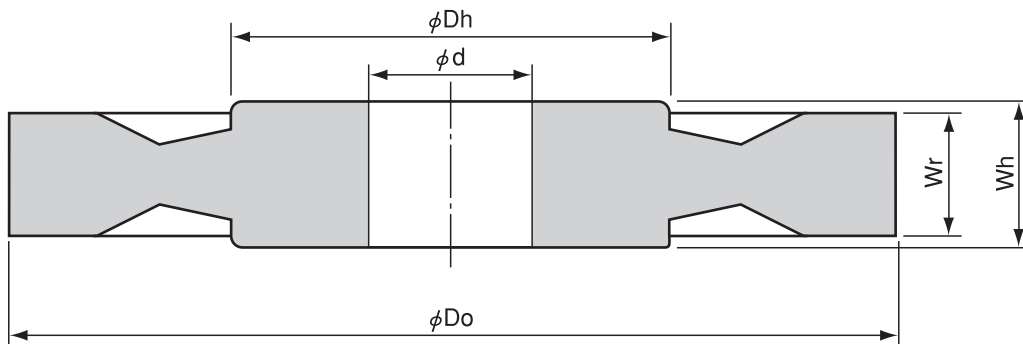

● Blank material without ditch

No.	Do mm	Dh mm	d mm	Wh mm	Wr mm	Possible pressurized insertion bearing outer diameter mm	Weights g/pc
2013N	281	138	50	45	35	55~100	2.4
2014N	315	151	60	50	40	65~110	3.3
2016N	360	174	80	55	45	85~130	4.8
2018N	405	198	90	60	50	95~150	6.7
2020N	450	211	110	65	55	115~160	8.7
2023N	504	236	120	70	60	125~180	12.0

※Maximum allowable weight is a reference at vertical weight

Black numbers : Standard item
 Blue numbers : Non-Standard item
 - : Not manufactured

NYLATRON® SHEAVE (Injection Sheave)

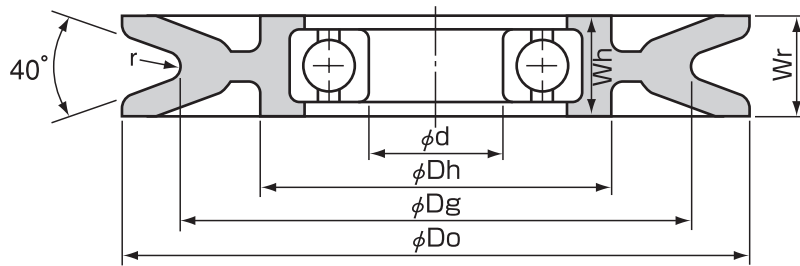

● Sheave Ratio 16

No.	Applied rope diameters mm	Do mm	Dg mm	Dh mm	d mm	Wh mm	Wr mm	r mm	Bearing No.	Maximum allowable weight N	Weights g/pc
Dg137×9B	9	169	137	92	35	28	28	5	6207ZZ	13,729	650

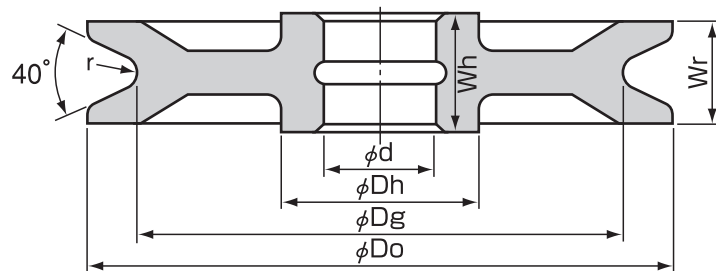

● Sheave Ratio 16

No.	Applied rope diameters mm	Do mm	Dg mm	Dh mm	d mm	Wh mm	Wr mm	r mm	Maximum allowable weight N	Weights g/pc
Dg137×9	9	169	137	50	35 ^{+0.4} / _{+0.2}	30 ⁰ / _{-0.5}	28	5	8,826	370

※ Maximum allowable weight is a reference at vertical weight

Black numbers : Standard item
 Blue numbers : Non-Standard item
 - : Not manufactured

NYLATRON[®] SHEAVE (Injection Sheave)

4-20

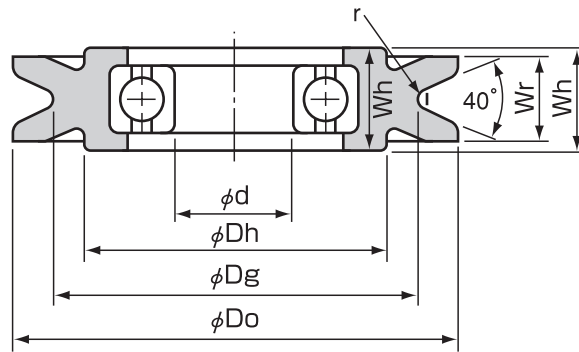

6-20

8-20

9-20

10-20

12-20

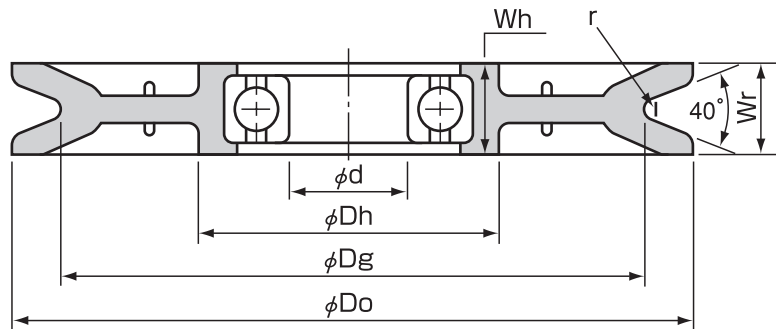

16-20

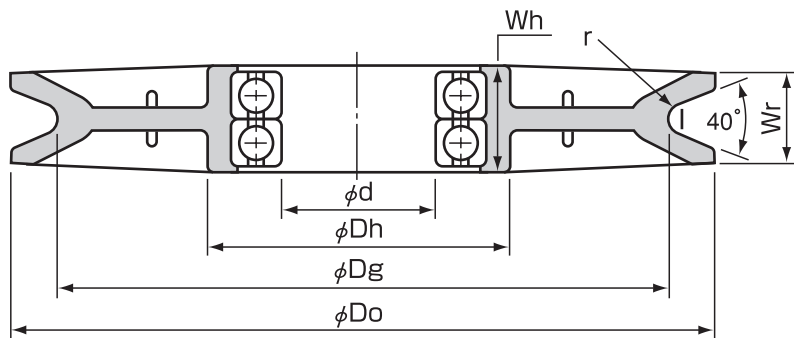

● Sheave Ratio 20

No.	Applied rope diameters mm	Do mm	Dg mm	Dh mm	d mm	Wh mm	Wr mm	r mm	Bearing No.	Maximum allowable weight N	Weights g/pc
4-20	4	96	78	65	25	23	18	2.2	6205ZZ	3,923	211
6-20	6	139	117	78	30	25	21	3.3	6206ZZ	9,807	396
8-20	8	184	156	100	35	31	27	4.4	6307ZZ	17,652	906
9-20	9	208	176	100	35	31	31	5.0	6307ZZ	17,652	1,025
10-20	10	231	195	110	40	35	31	5.5	6308ZZ	22,555	1,350
12-20	12	276	234	120	45	38	35	6.6	6309ZZ	30,401	2,000
16-20	16	352	304	170	70	52	46	8.5	6214ZZ×2	74,531	4,400

※Maximum allowable weight is a reference at vertical weight

Black numbers : Standard item
 Blue numbers : Non-Standard item
 - : Not manufactured

NYLATRON[®] SHEAVE (Injection Sheave)

Sheave Ratio 25

4-25
5-25
6.3-25
8-25

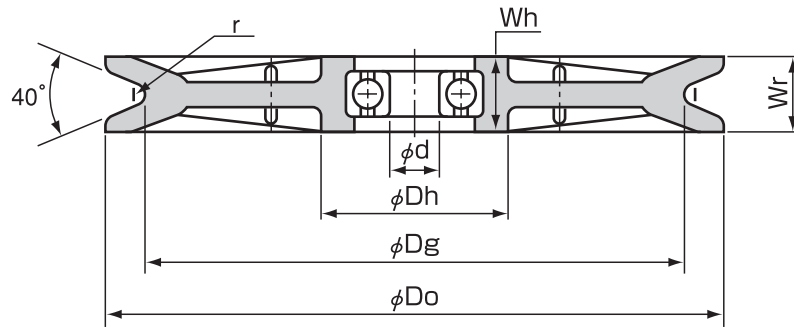

Sheave Ratio 30

6.3-30

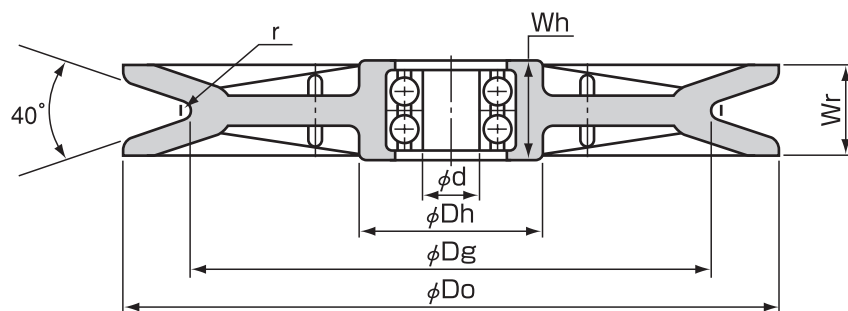

● Sheave Ratio 25

No.	Applied rope diameter mm	Do mm	Dg mm	Dh mm	d mm	Wh mm	Wr mm	r mm	Bearing No.	Maximum allowable weight N	Weights g/pc
4-25 (1)	4	116	99	44	10	17	15	2.2	6200ZZ	2,256	130
4-25 (2)	4	116	99	44	12	17	15	2.2	6201ZZ	2,648	132
5-25	5	145	123	63	20	22	20	2.8	6204ZZ	5,982	293
6.3-25	6.3	183	156	63	20	24	22	3.5	6204ZZ	4,707	440
8-25	8	232	196	68	20	27	27	4.4	6304ZZ	6,080	780

● Sheave Ratio 30

No.	Applied rope diameter mm	Do mm	Dg mm	Dh mm	d mm	Wh mm	Wr mm	r mm	Bearing No.	Maximum allowable weight N	Weights g/pc
6.3-30	6.3	236	190	67	15	32	32	3.5	6302ZZ×2	6,347	920

※Maximum allowable weight is a reference at vertical weight

Black numbers : Standard item
Blue numbers : Non-Standard item
- : Not manufactured